

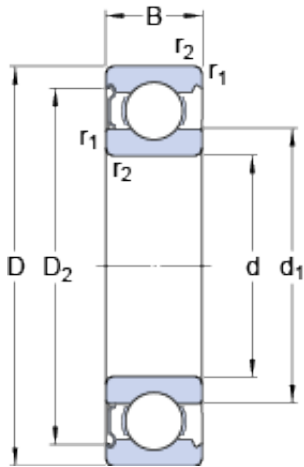

KAWASAKI PUMP LTD



625-Z Bearing 2D drawings and 3D CAD models

SKF 625-Z * 625-2z * 635-Z * 635-2z * 635-Rz *
 635-2rz * 635-RS1 * 635-2RS1 * 635 * 618/6
 628/6-2z 619/6-2z 619/6 626 * 626-2rsh * Deep
 Groove Ball Bearing

Bearing No. 625-Z

Size	16x5x5 mm
Bore Diameter	16 mm
Outer Diameter	5 mm
Width	5 mm
d	5 mm
D	16 mm
B	5 mm
d ₁	8.4 mm
D ₂	13.22 mm
r _{1,2} - min.	0.3 mm
d _a - min.	7.4 mm
d _a - max.	8.3 mm
D _a - max.	13.6 mm
r _a - max.	0.3 mm
Basic dynamic load rating - C	1.1 kN
Basic static load rating - C ₀	0.38 kN
Fatigue load limit - P _u	0.016 kN
Reference speed	95000 r/min
Limiting speed	60000 r/min
Calculation factor - k _r	0.025
Calculation factor - f ₀	8.4
Size	16x5x5 mm



KAWASAKI PUMP LTD

Bore Diameter	16 mm
Outer Diameter	5 mm
Width	5 mm
d	5 mm
D	16 mm
B	5 mm
d ₁	8.4 mm
D ₂	13.22 mm
r _{1,2} - min.	0.3 mm
d _a - min.	7.4 mm
d _a - max.	8.3 mm
D _a - max.	13.6 mm
r _a - max.	0.3 mm
Basic dynamic load rating - C	1.1 kN
Basic static load rating - C ₀	0.38 kN
Fatigue load limit - P _u	0.016 kN
Reference speed	95000 r/min
Limiting speed	60000 r/min
Calculation factor - k _r	0.025
Calculation factor - f ₀	8.4
Category	Single Row Ball Bearings
Inventory	0.0
Manufacturer Name	SKF
Minimum Buy Quantity	N/A
Weight / Kilogram	0.007
EAN	7316577112088
Product Group	B00308
Enclosure	1 Metal Shield
Precision Class	ABEC 1 ISO P0
Maximum Capacity / Filling Slot	No



KAWASAKI PUMP LTD

Rolling Element	Ball Bearing
Snap Ring	No
Internal Special Features	No
Cage Material	Steel
Internal Clearance	C0-Medium
Inch - Metric	Metric
Long Description	5MM Bore; 16MM Outside Diameter; 5MM Outer Race Width; 1 Metal Shield; Ball Bearing; ABEC 1 ISO P0; No Filling Slot; No Snap Ring; No Internal Special Features; C0-Medium Internal Clearance; Steel C
Other Features	Deep Groove
Category	Single Row Ball Bearing
UNSPSC	31171504
Harmonized Tariff Code	8482.10.50.68
Noun	Bearing
Keyword String	Ball
Manufacturer URL	http://www.skf.com
Manufacturer Item Number	625-Z
Weight / LBS	0.016
Bore	0.197 Inch 5 Millimeter
Outside Diameter	0.63 Inch 16 Millimeter
Inner Race Width	0 Inch 0 Millimeter
Outer Race Width	0.197 Inch 5 Millimeter
bore diameter:	5 mm
static load capacity:	0.38 kN
outside diameter:	16 mm
precision rating:	ABEC 3 (ISO Class 6)
overall width:	5 mm
finish/coating:	Uncoated
bore type:	Round



KAWASAKI PUMP LTD

cage material:	Steel
closure type:	Single Shield
outer ring width:	5 mm
row type & fill slot:	Single Row Non-Fill Slot
fillet radius:	0.3 mm
snap ring included:	Without Snap Ring
maximum rpm:	48000 RPM
internal clearance:	C0
series:	62
dynamic load capacity:	1.14 kN
d_1	8.4 mm
D_2	13.22 mm
$r_{1,2}$ min.	0.3 mm
d_a min.	7.4 mm
d_a max.	8.3 mm
D_a max.	13.6 mm
r_a max.	0.3 mm
Basic dynamic load rating C	1.14 kN
Basic static load rating C_0	0.38 kN
Fatigue load limit P_u	0.016 kN
Calculation factor k_r	0.025
Calculation factor f_0	8.4
Mass bearing	0.005 kg